

# Stainless Steel Conveyor Accessories DA

AP TR MS2 ML2 MM3 MX2 MT2 MR2 MG MB MA DM3 DS2 DX2 DT2 DR2 DG DF2 DB DA SD SE TL IM MM

Please consult MODU representative for further information and assistance.

Units: Dimension (mm)

## Fasteners

### Cap Screw, M6 & M8

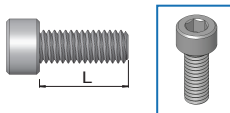

Material: Stainless Steel

Item Code	Description	Weight	Supply
DA BC M6x16	M6x16mm	0.6 kg	100 pcs/pkt
DA BC M8x16	Anti-Static	1.2 kg	100 pcs/pkt
DA BC M8x 20	POM-Kevlar	1.3 kg	100 pcs/pkt

### Lock Nut, M6, M8 & M10



Material: Stainless Steel

Item Code	Weight	Supply
DA NL 6	0.5 kg	200 pcs/pkt
DA NL 8	1.0 kg	200 pcs/pkt
DA NL 10	0.6 kg	50 pcs/pkt

### Locking Washer



- Locking washer for friction & gripper pad

Item Code	Weight	Supply
MA WL 5	0.01 kg	50 pcs/pkt

### Floor Anchor Bolt



- M10 Drop in Floor Anchor Bolt

Material: Stainless Steel

Item Code	Weight	Supply
DA BF M10	2.5 kg	50 pcs/pkt

### Hex Head Bolt, M6, M8 & M10

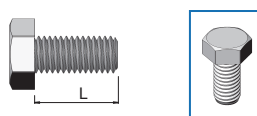

Material: Stainless Steel

Item Code	Description	Weight	Supply
DA BH M6x 16	M6x16mm	0.6 kg	100 pcs/pkt
DA BH M6x 20	M6x 20mm	0.8 kg	100 pcs/pkt
DA BH M8x 16	M8x 16mm	1.2 kg	100 pcs/pkt
DA BH M8x 20	M8x 20mm	1.3 kg	100 pcs/pkt
DA BH M8x 25	M8x 25mm	1.3 kg	100 pcs/pkt
DA BH M8x 40	M8x 40mm	1.6 kg	100 pcs/pkt
DA BH M10x 20	M10x 20mm	2.2 kg	100 pcs/pkt

### Countersunk Screw

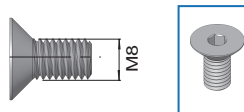

Material: Stainless Steel

Item Code	Weight	Supply
DA SC M8x 16	0.7 kg	100 pcs/pkt
DA SC M8x 20	0.8 kg	100 pcs/pkt

### Button Head Bolt

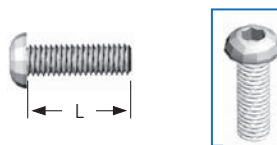

Material: Stainless Steel

Item Code	Description	Weight	Supply
DA BB M6x 10	M6x10mm	1.0 kg	100 pcs/pkt
DA BB M6x 12	M6x 12mm	1.1 kg	100 pcs/pkt
DA BB M6x 16	M6x 16mm	1.2 kg	100 pcs/pkt
DA BB M8x 16	M8x 16mm	1.4 kg	100 pcs/pkt
DA BB M8x 20	M8x 20mm	1.6 kg	100 pcs/pkt

Please consult MODU representative for further information and assistance.

Units: Dimension (mm)

## Fasteners

### Rivet



Material: Aluminium

Item Code	Weight	Supply
MA RR 3	0.2 kg	50 pcs/pkt

### Flat Washer, M6, M8 & M10



Material: Stainless Steel

Item Code	Weight	Supply
DA WF 6	0.25 kg	200 pcs/pkt
DA WF 8	0.48 kg	200 pcs/pkt
DA WF 10	0.80 kg	50 pcs/pkt

### Blind Rivet

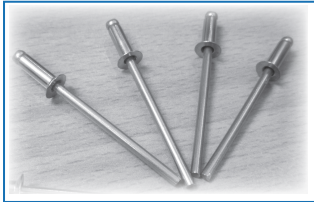

Material: Stainless Steel

Item Code	Weight	Supply
DA RB 3.2x9	0.2 kg	100 pcs/pkt

### Connecting Strip

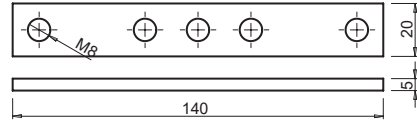

- 4 pcs M8 Screw included.

Material: Stainless Steel



Item Code	Weight	Supply
DA CS 20x140	1.1 kg	10 pcs/pkt

### Connecting Strip

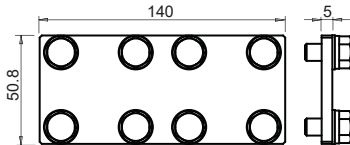

Item Code	Weight	Supply
DA CS 5x50.8x115	3.0 kg	10 pcs/pkt

Material: Stainless Steel

- 8 pcs M8 Screw included.

